

PRODUCT WARNING

READ AND SAVE THESE INSTRUCTIONS. TO REDUCE THE RISK OF FIRE, ELECTRIC SHOCK, OR INJURY TO PERSONS, OBSERVE THE FOLLOWING:

1. Read all instructions before installing and using this product.
2. This product is not intended for users by persons (including children) with reduced physical, sensory, or mental capabilities, or lack experience with and knowledge, unless they have been given supervision or instruction concerning use of appliance by a person responsible for their safety.
3. Ensure your power source conforms to the electrical requirements of this product.
4. Do not attempt to hardwire this product. Performing any retrofitting actions may result in personal injury and/or electrical damage, and will void this product's warranty.
5. Be careful not to damage or cut the wire insulation (covering) during the installation. Do not permit wires to come in contact with any sharp edges.
6. This product must not be used or placed in potentially hazardous locations such as flammable, explosive, electrical, chemical-laden, or wet atmospheres.
7. Do not cover any power cords with rugs or other fabric materials.
8. Safety precautions should be exercised during the installation, operation, and maintenance of this product.
9. Do not tamper with this product in any manner, or allow fingers or foreign objects to enter any openings while it is in operation as it may cause electric shock, fire, or damage to this product.
10. Do not depend on the on/off programming as the sole means of shutting power from this product. Unplug the power cord before installing, servicing, or moving this product.
11. Do not operate this product while its cord is damaged, or if it malfunctions, has been dropped, or is damaged in any manner.

1

CONTENTS AND FEATURES

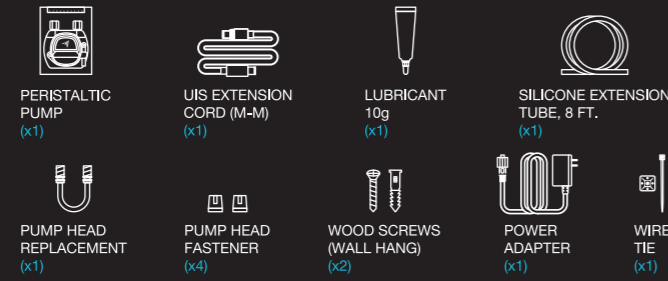

ACCURATE DOSING

10 speed levels accurately distribute liquid in milliliters (mL) per minute to produce measurable results.

LONG-LASTING

Cutting-edge DC motor is designed for low noise and energy-efficient operation for years of extended use.

VERSATILE USAGE

This multi-faceted device can seamlessly add various liquids such as pH, EC, and TDS-concentrated nutrients.



MULTI-FUNCTIONAL

This versatile pump can be used for many applications like hydroponics, aquariums, and other scientific purposes.

DURABLE TUBING

Equipped with a durable BPT pump head that allows for use with a wide variety of alkali and acidic liquids.

UIS™ COMPATIBLE

Connect to AI and UIS™ controllers to access intelligent programming, app controls and advanced automations.

2

INSTALLATION

STEP 1

Cut the extension tube to your desired length.



STEP 2

Unscrew the pump head caps.

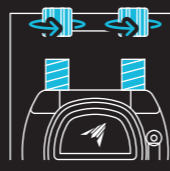

STEP 3

Lead the cut extension tubes through the caps.

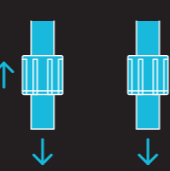

3

INSTALLATION

STEP 4

Place the pump head fasteners onto the ends of the cut extension tubes.

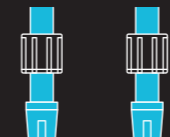

STEP 5

Insert the extension tubes and pump head fasteners into the pump heads and screw the caps back on to secure the connection.

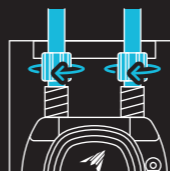

Do NOT overtighten.

STEP 6

Lead the IN tube to the container you want to pump liquid into.

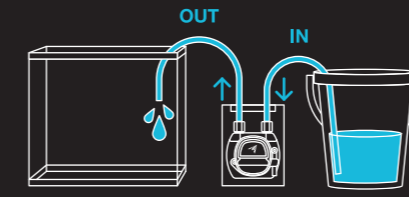

4

INSTALLATION MOUNTING

DESKTOP

You may set your pump on your desktop near your container and/or target.



STEP 1 – WALL MOUNTING

Locate a spot free of obstruction and secure the anchors into your wall. Twist the wood screws into the anchors.

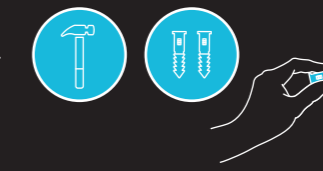

STEP 2 – WALL MOUNTING

Hang your pump by the screws using the holes on the backside.

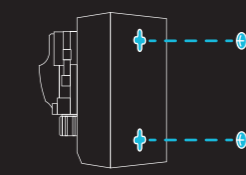

5

POWERING AND SETUP

STEP 1

Connect the power adapter's male connector to the female end of your pump's power cord.

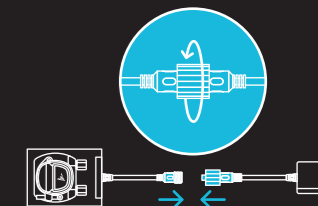

Secure the connection using the twist-on piece.

STEP 2

Plug the power cord into an AC power outlet to power your pump.

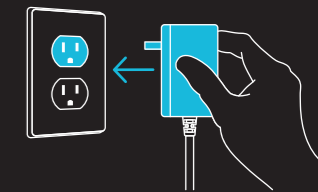

6

POWERING AND SETUP

POWER ON/OFF AND CYCLING

Press the power button to turn your pump on and adjust its speed level. It will default to speed level 6 upon first-time use. Passing speed level 10 will turn it off. Hold the button for 2 seconds to turn it off from any level.



LEVEL	1	2	3	4	5	6	7	8	9	10
FLOW RATE (mL/min)	21	42	63	84	105	126	147	168	189	210

MEMORY RETENTION

The indicator lights will shut off after 10 seconds of running. Your pump will continue to run after this shut-off. Pressing the power button will turn the indicator lights back on. Press the power button after this to adjust the speed level.

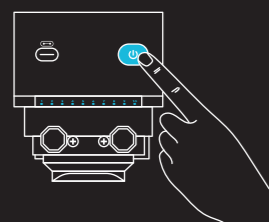

Your pump will operate at the last saved speed level when powered back on in the event of a power outage.

7

CONNECTING TO UIS™

The peristaltic pump can connect to all smart UIS controllers (sold separately) as part of an integrated system using the included UIS extension cord.

EXTENSION CABLE

You may plug the included UIS extension cord into the top side port to connect your pump to your UIS controller.

Plug the UIS connector with the gasket end into your pump. The gasket is specially designed to protect against liquids and dust.



Your controller will override all onboard settings, assume control (parameters must be adjusted on your controller), and shut off your pump's display and touch functions when connected in this manner.



8

MAINTENANCE

STEP 1

Loosen the screws at the top of the pump frame and set them aside.

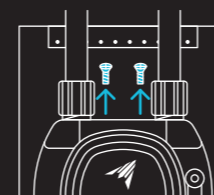
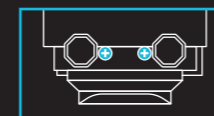

STEP 2

Unfasten the dampener to open the bottom latch and remove the motor cap.

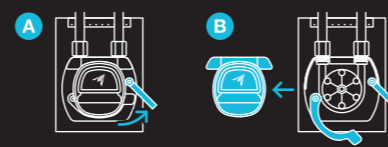

STEP 3

Unscrew the pump head caps to release the extension tubes and the pump head from the motor.

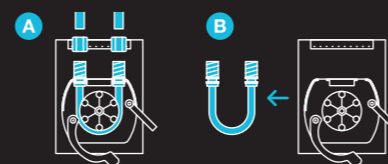

9

MAINTENANCE

STEP 4 – LUBRICATION

Lubricate the inner side of the pump head tube.



Replace the pump head, motor cap, and screws to lock the pump head back into place.

STEP 4 – REPLACEMENT

Remove the old pump head with the pump head replacement.

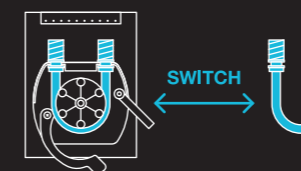

Replace the motor cap, extension tubes, and screws to lock the pump head back into place.

10

MORE INFORMATION



PROGRAMMING

For in-depth programming instructions, scan this QR code to view a digital manual.



AC INFINITY APP

For advanced automations, download the AC Infinity app and make sure your pump is plugged in and powered on.

WARRANTY

Our warranty program is our commitment to you, the original customer, that product sold by AC Infinity Inc. will be free from defects for TWO YEARS from the date of purchase. If you have any issues with this product, contact us and we'll happily resolve your problem or issue a full refund!



WEBSITE | www.acinfinity.com
EMAIL | support@acinfinity.com
PHONE | 626-923-6399, 9 am to 5 pm PST
ADDRESS | 21880 BAKER PARKWAY
CITY OF INDUSTRY, CA 91789

DEALERS
EMAIL | dealers@acinfinity.com
PHONE | 626-838-4656, 9 am to 5 pm PST

MANUAL CODE PDP2502X1

COPYRIGHT © 2025 AC INFINITY INC. ALL RIGHTS RESERVED

No part of the materials including graphics or logos available in this booklet may be copied, photocopied, reproduced, translated or reduced to any electronic medium or machine readable form, in whole or in part, without specific permission from AC Infinity Inc.

11

PERISTALTIC PUMP

QUICK START GUIDE